

Maldives Land and Survey Authority,

MINISTRY OF HOUSING AND INFRASTRUCTURE

Ameenee Magu, Maafannu, Male', 20392, Maldives.

Office (PABX): +(960) 3004300, Fax: +(960) 3004254

Email: survey@mhe.gov.mv

Web: www.surveyofmaldives.gov.mv, www.mhe.gov.mv



CONTROL POINT DETAILS	Station Number <i>PSM5250</i>
Coordinate Information	
Geodetic	Grid
WGS 84	UTM Zone 43
Lat: 04° 06' 20.4804"	E: 336284.9127
Long: 73° 31' 30.4900"	N: 453960.6281
Ellp Height:	Orth Height: +1.539
Island Name: South Kaafu Atoll Emboodhoofinolhu	Date: 20 th – 21 st May 2012

Monument description & method of survey:

- PSM5250 monument type - Type A.
- The coordinates (E, N) is derived after computation using PSM 5251
- Level was determined using tide data provided by Met.

General site condition & access:

- PSM5250 was to be established in the vegetation line of the island.
- PSM5250 is located on South Kaafu Atoll Emboodhoofinolhu on the Staff Area near Supply Jetty.
- PSM5250 is located in an area which is easy to access and locate.

Owner: Taj Exotica Resort and Spa



DOWN VIEW



NORTH VIEW



EAST VIEW



TOP VIEW



SOUTH VIEW



WEST VIEW

SITE INFORMATION

Station Number

P S M 5 2 5 0

Station Horizon Mask

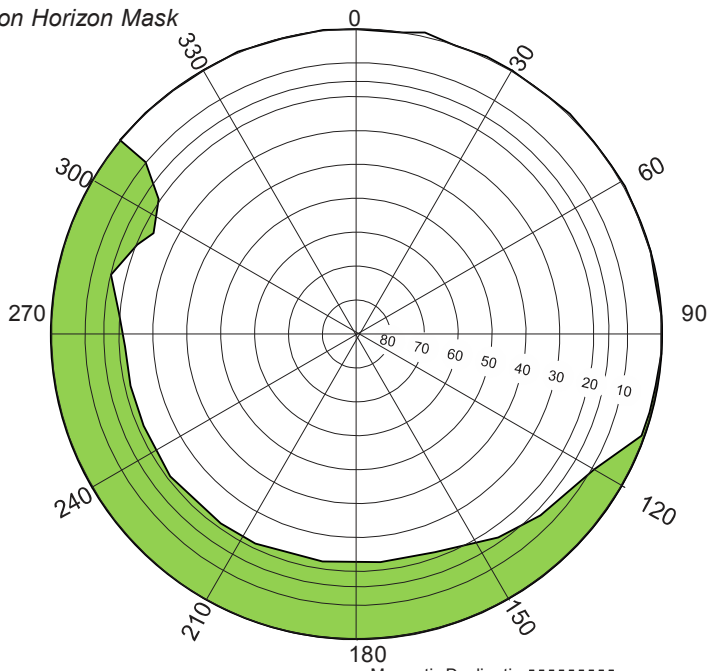

Height above Marker that horizon was mapped from 1.500 m

Magnetic Declination -----
Declination applied to this figure?
 Yes No



Locality

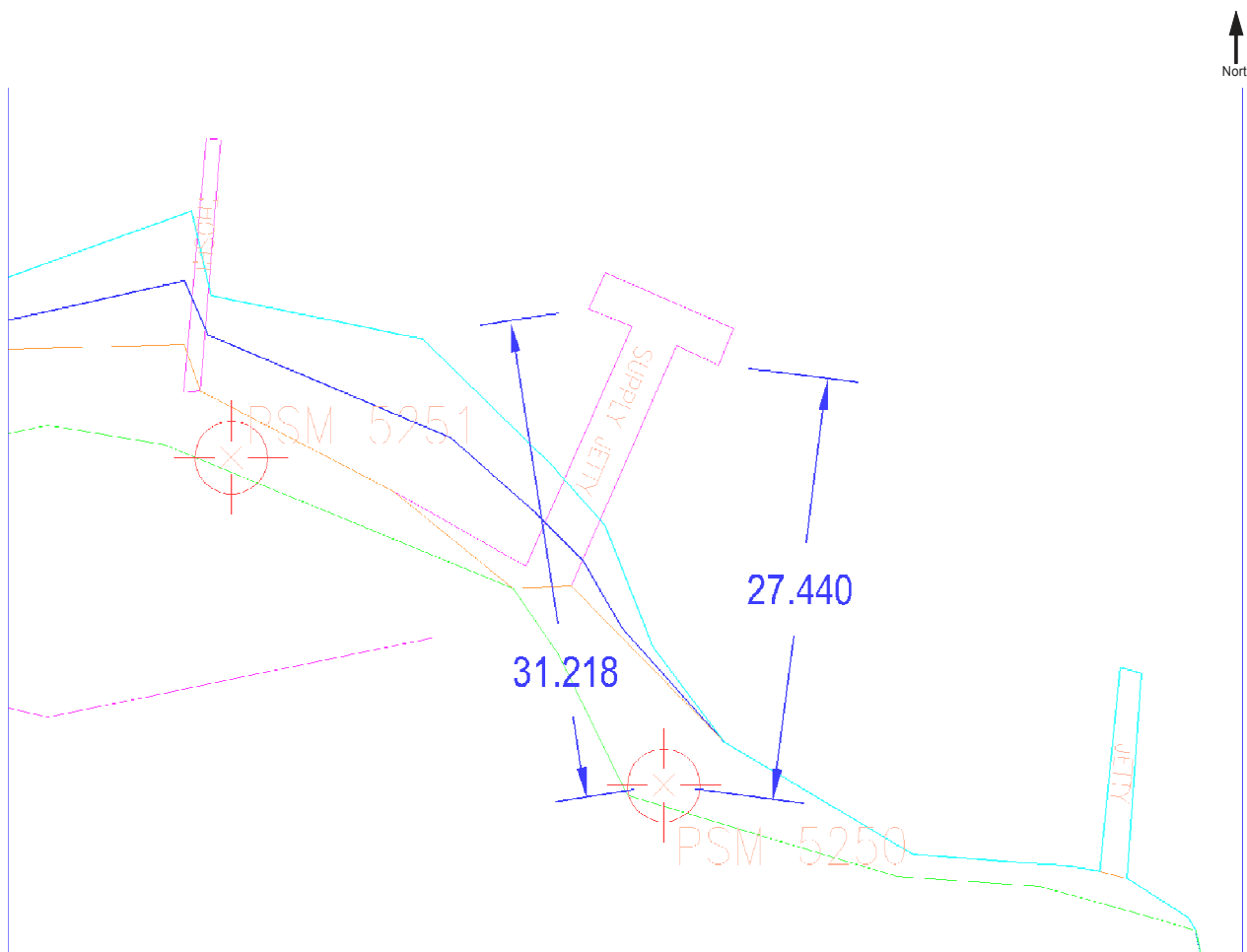
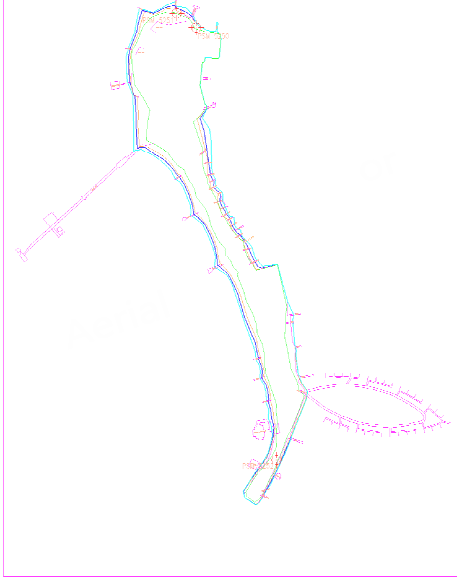

Sketched by: Hazim Rasheed (Hardy)

Scale: Not to scale

Date: 20th/21st May 2012

Maldives Land and Survey Authority,

MINISTRY OF HOUSING AND INFRASTRUCTURE

Ameenee Magu, Maafannu, Male', 20392, Maldives.

Office (PABX): +(960) 3004300, Fax: +(960) 3004254

Email: survey@mhe.gov.mv

Web: www.surveyofmaldives.gov.mv, www.mhe.gov.mv



CONTROL POINT DETAILS	Station Number PSM5251
Coordinate Information	
Geodetic	Grid
WGS 84	UTM Zone 43
Lat: 04° 06' 21.1680"	E: 336256.9200
Long: 73° 31' 29.5820"	N: 453981.8500
Ellp Height:	Orth Height: +1.318 m
Island Name: South Kaafu Atoll Emboodhoofinolhu	Date: 20 th – 21 st May 2012

Monument description & method of survey:

- PSM5251 monument type - Type A.
- The coordinates (E, N) is Geo referenced using *Trimble GeoExplorer (Geo XH - 2008 Series)*
- Level was determined using tide data provided by Met.

General site condition & access:

- PSM5251 was to be established in the vegetation line of the island.
- PSM5251 is located on South Kaafu Atoll Emboodhoofinolhu on the Staff Area near Supply Jetty.
- PSM5251 is located in an area which is easy to access and locate.

Owner: *Taj Exotica Resort and Spa*



DOWN VIEW



NORTH VIEW



EAST VIEW



TOP VIEW



SOUTH VIEW



WEST VIEW

SITE INFORMATION

Station Number

P S M 5 2 5 1

Station Horizon Mask

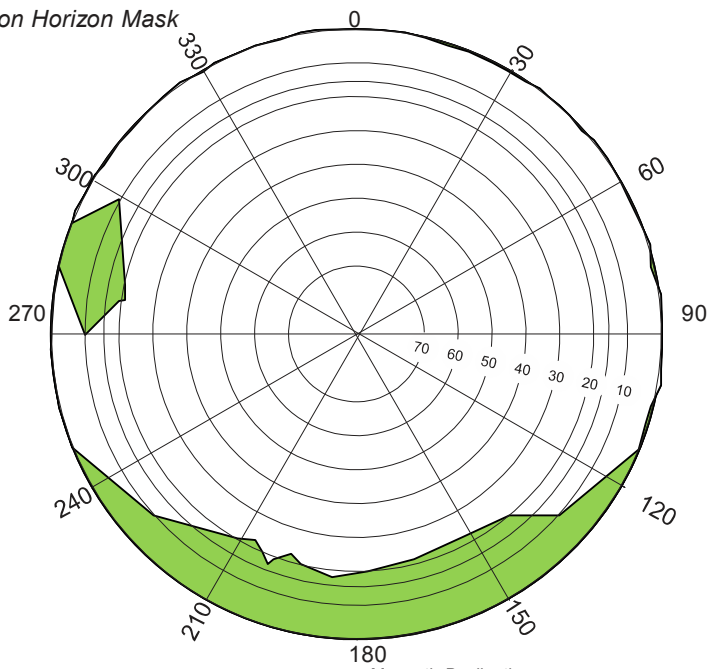

Height above Marker that horizon was mapped from 1.500 m

Magnetic Declination -----
Declination applied to this figure?
 Yes No

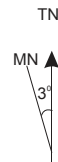

Locality

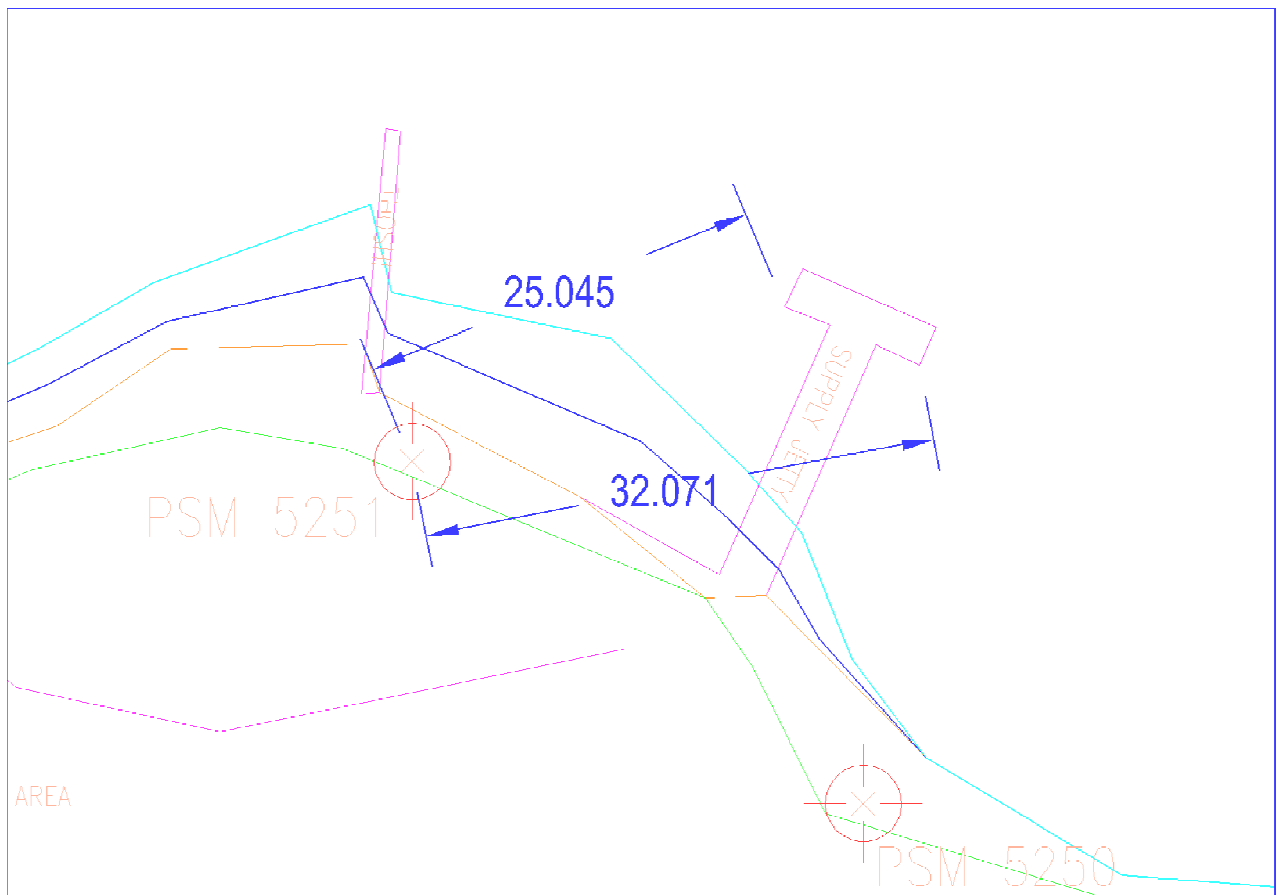

Sketched by: Hazim Rasheed (Hardy)

Scale: Not to scale

Date: 20th/21st May 2012

Maldives Land and Survey Authority,

MINISTRY OF HOUSING AND INFRASTRUCTURE

Ameenee Magu, Maafannu, Male', 20392, Maldives.

Office (PABX): +(960) 3004300, Fax: +(960) 3004254

Email: survey@mhe.gov.mv

Web: www.surveyofmaldives.gov.mv, www.mhe.gov.mv



CONTROL POINT DETAILS	Station Number <i>PSM5252</i>
Coordinate Information	
Geodetic	Grid
WGS 84	UTM Zone 43
Lat: 04° 06' 00.1044"	E: 336400.8705
Long: 73° 31' 34.2880"	N: 453334.6156
Ellp Height:	Orth Height: +0.680 m
Island Name: South Kaafu Atoll Emboodhoofinolhu	Date: 20 th – 21 st May 2012

Monument description & method of survey:

- PSM5252 monument type - Type A.
- The coordinates (E, N) is derived after computation using PSM 5251
- Level was determined using tide data provided by Met.

General site condition & access:

- PSM5252 was to be established in the vegetation line of the island.
- PSM5252 is located on South Kaafu Atoll Emboodhoofinolhu on the Guest Area near Gymnasium and Yoga Pavilion.
- PSM5252 is located in an area which is easy to access and locate.

Owner: *Taj Exotica Resort and Spa*



DOWN VIEW



NORTH VIEW



EAST VIEW

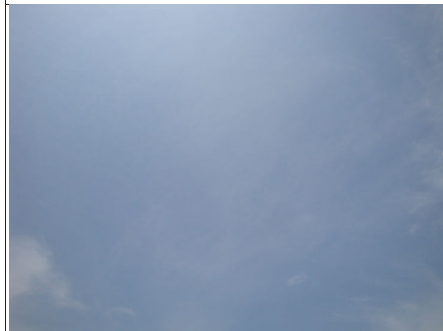

TOP VIEW



SOUTH VIEW



WEST VIEW

SITE INFORMATION

Station Number

P	S	M	5	2	5	2
---	---	---	---	---	---	---

Station Horizon Mask

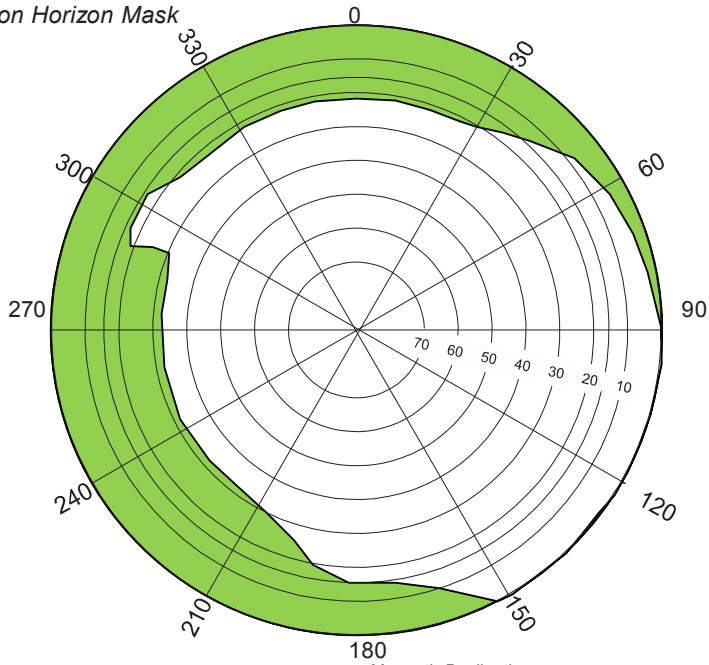

Locality



Height above Marker that horizon was mapped from 1.500 m

Magnetic Declination -----
Declination applied to this figure?
 Yes No

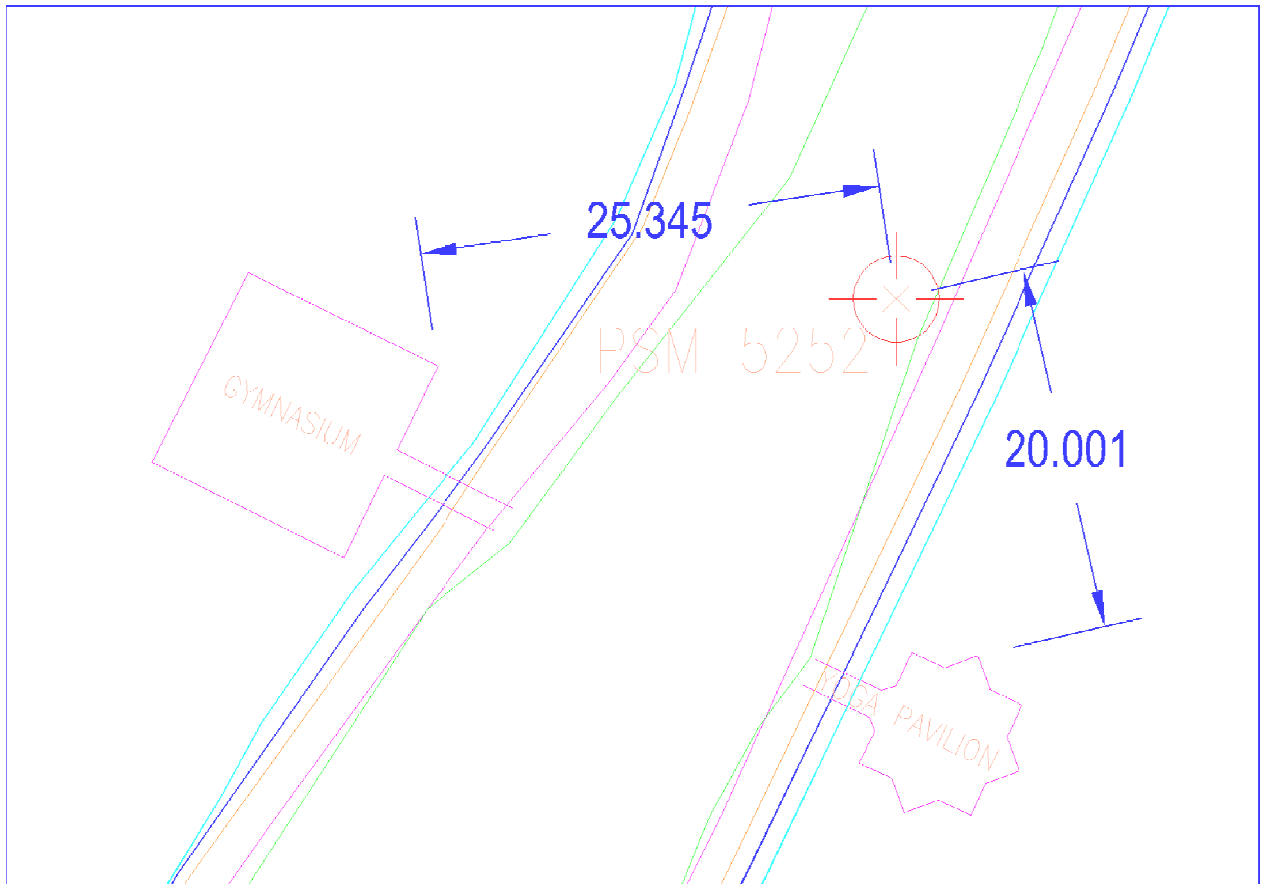

Sketched by: Hazim Rasheed (Hardy)

Scale: Not to scale

Date: 20th/21st May 2012